

The archeology is a compass of the futures

# Kochi Prefecture Archeological Center



## The purport of the foundation

The Kochi Prefecture Archeological Center was founded in 1991 to protect and hand down cultural heritage to posterity.

From 2012, the Kochi Prefecture Foundation for Culture receives the trust from the Kochi Prefecture and manages facility as the designated manager in addition to work of excavation.



Remains of Higashino-doi, Konan City  
Yayoi pottery, Urn; Late of the Yayoi period

## Contents of works

- ❖ about excavation of the archaeological relics
- ❖ about survey and research of the archaeological relics
- ❖ about management of the archaeological relics
- ❖ about popularization such as exhibition of the archaeological relics
- ❖ about administration of the Kochi Prefecture Archeological Center
- ❖ about other necessary duties to achieve Kochi Prefecture Archeological Center founding purpose

## Outline of the facilities

There is an office room, an exhibition room, a special storage room, a library, and a photographic film storage room in the main building, and our center performs a public display and an open lecture there. In addition, there is a training room, an experiencing room in the north building, and our center performs a public display, an experiencing classroom, a family archeology classroom there mainly.

Our center makes an investigation into relics in the south building mainly, and keeps relics in the storage room.

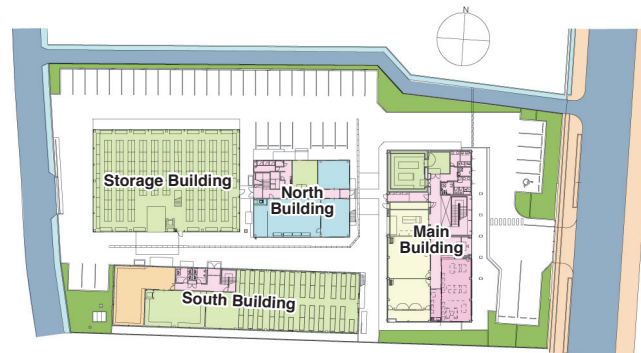

## Facilities information

**Opening hours:** 8:30–17:00

**Days Closed:** Saturday, Sunday and national holiday except the public exhibition period, New Year's holiday: December 29 to January 3

**Admission fees:** free of charge

**Parking space:** 4 space for standard-sized cars, 1 space marked for the disabled, 2 spaces for Large-sized buses  
36 spaces for standard-sized cars on Sunday and national holiday

## Transport Access

### Car

About 15 minutes from Nankoku IC

About 10 minutes from Nankoku South IC

About 15 minutes from Kochi Ryoma Airport

### JR Shikoku

About 15 minutes walk from Gomen Station

### Tram

About 6 minutes walk from Sumiyoshi Douri or Higashi Kougyou koukou Mae

### Fixed-route bus

About 3 minutes walk from Wakamiya Hatimangu Mae

About 10 minutes walk from Kogyou Danti Mae

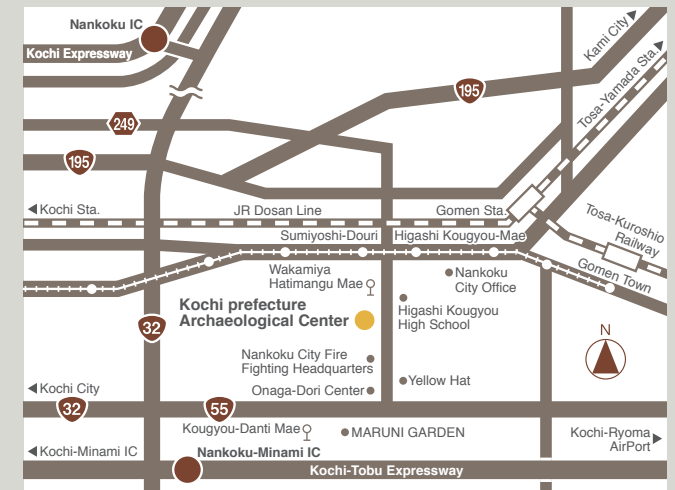

## The Kochi Prefecture Foundation for Culture Kochi Prefecture Archeological Center

1437-1, Shinohara, Nankoku City, Kochi Prefecture 783-0006

TEL: 088-864-0671 FAX: 088-864-1423

URL: <http://www.kochi-maibun.jp/>

Email: [maibun@kochi-bunkazaidan.or.jp](mailto:maibun@kochi-bunkazaidan.or.jp)

## Disclosure of information

### Home Page

Our center utilize the Internet and release it that the information of various lectures, exhibitions, excavation situation at any time. In addition, our center offers archeological reports and public publications in Portable Document Format, and freely can download it.



### Rental of properties owned by the Kochi Prefecture

Our center rent relic and photograph owned by the Kochi Prefecture that managing in Kochi Prefecture Archeological Center.



### Reception of a facility tour

Our center accepts facility tour, training, display explanation, and workplace experience in the group.

## Public display

Our center plans protection and popularization enlightenment of cultural properties by showing production of the excavation and excavated archaeological relics to many people of Kochi Prefecture widely. In addition, our center performs exhibitions briefing exhibition lecture and display explanation with the goal of contributing to the succession of the history and culture.



## Open lecture

Our center performs a trial class based on excavated relics, and various lectures about basic history and Result of excavation to have many people raise interest about archeological basic knowledge and local history. In addition, our center performs family archeology classroom that experience the life of ancient people through-out story of ruins, history of Kochi Prefecture, making of fire, and making of comma-shaped bead in summer.



## Delivery archeology classroom

Our center performs delivery archeology classroom about the cultural properties protection. The investigator goes to school in the prefecture that have a classroom about archaeology, making of fire, and making of comma-shaped bead.



## Archeological Center Festival

Our center performs trial class and backyard tour for raise awareness to cultural properties protection and deepen interest in cultural properties, and have many people know the activity of the Kochi Prefecture Archeological Center.

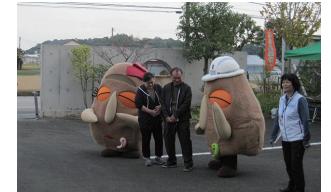

## Work of Excavation

Our center performs excavation of historic ruins for the development including the road construction and the river improvement. The excavation is performed for record preservation, and after field-work was finished; our center arrange relics for the report making.



### Excavation

We senses information in soil as much as possible, and write down the necessary information. This is the work that knowledge, technique, and experience is required. We find many remains of an ancient including a pit house and an earthfast post building by the excavation. The new history may become clear by investigating them carefully.



### Arrangement

Our center arranges the relics and the record by excavation for making report about ancient of the ruins. This is the work that knowledge, technique, and experience is required as well as a fieldwork. The relics are published in the report after much work including washing, notation, joining, survey drawing, trace, restoration, and photography. In addition, we summarize the drawing and arrange the photograph. After having done it, we make an illustration and a plate in the report. At last, a manuscript is written by the data of relics, and we make the report that published survey drawing.

